

The MK series pumps are designed to complete the existing MG series with improve performances in terms of flow rate, pressure, capability to handle high viscosity fluids and a wider offer of materials to suit most applications, from the food to the industrial and chemical markets. The pump's housing and the internal metal parts are available in AISI 303, AISI 316L or SAF 2205. The gears are available in PTFE™ or Peek™. The driving magnet, available in Ferrite or in rare earths, is capable to drive the pump at high pressure. The quality of the materials of the assembled components allows handling of fluids with temperatures up to 120 °C (248 °F). The low noise and pulsation is the result of precision gears accurately assembled and balanced within the housing combined with the magnetic coupling wich grants the perfect alignment. The Sanitary design makes this pump series the preferred candidate for use in medical applications where trouble-free products are needed.

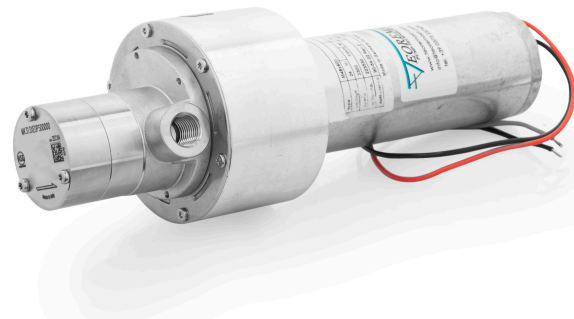

MAIN APPLICATION

- Medical and surgical
- Hemodialysis apparatus
- Laser apparatus
- Lubrication
- Ink-jet printing systems
- Cooling systems
- Laboratory instrumentation
- Water treatment
- Sampling
- Food processing



12 V

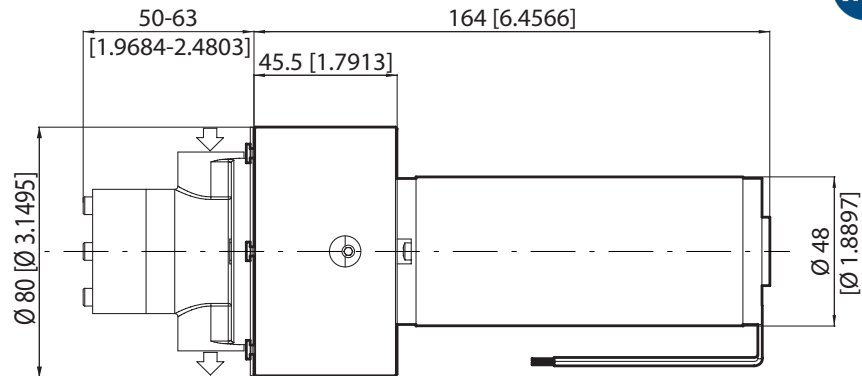

Dimensions in mm (inches)

24 V

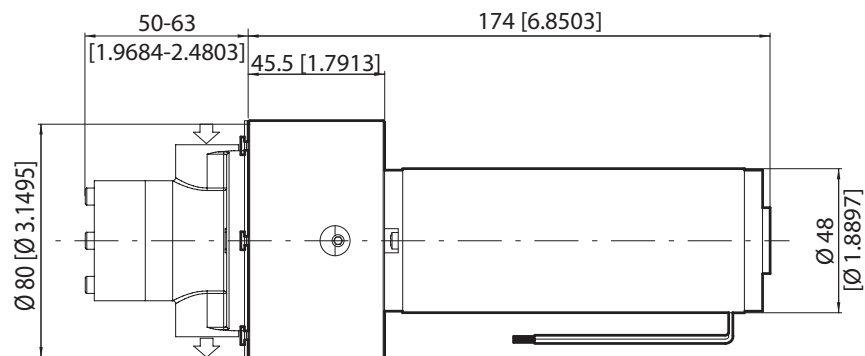

Dimensions in mm (inches)

POS	DESCRIPTION	FEATURES
A	Driving magnet	For 5 mm bore
A+B	Complete adapter	For KAG For KAG M48x60 M48x50
A+B+C	Complete motor assembly	See table below

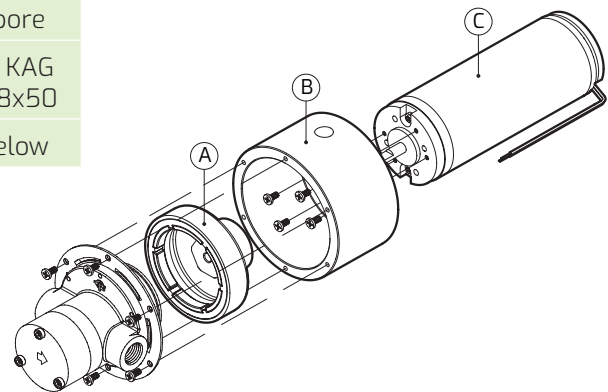

DRIVING UNIT	EXAMPLE	
Voltage (V)	12 DC	24 DC
Rated speed (rpm)	3050	3150
Current consumption (A)	3.4	2.6
Output power (W)	32	49,5
Motor IP protection	IP40	IP40
Weight (Kg)	1.2	1.3

MOTOR 12 VOLTS

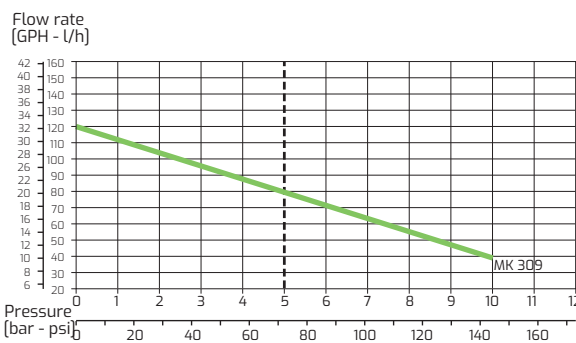

MOTOR 24 VOLTS

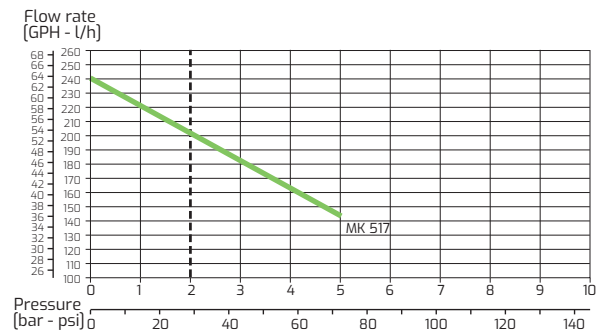
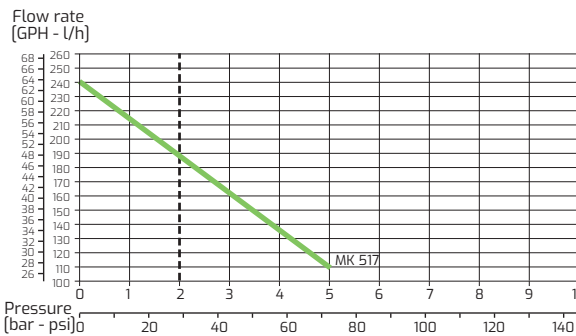
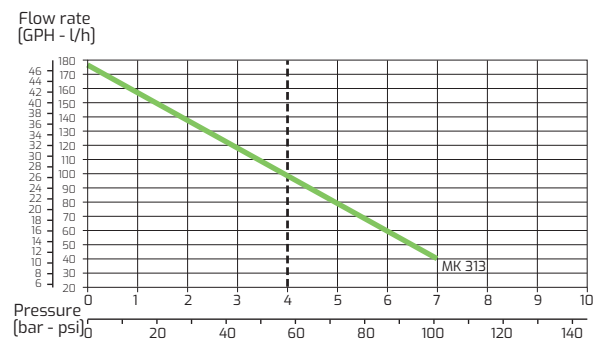
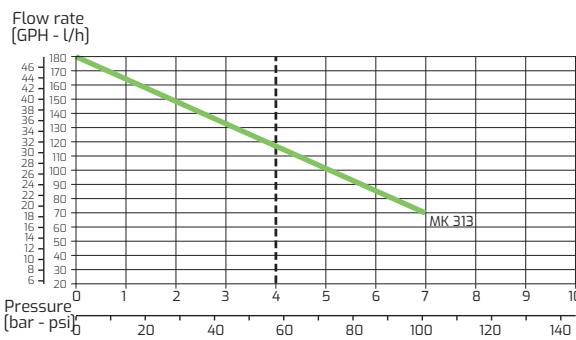
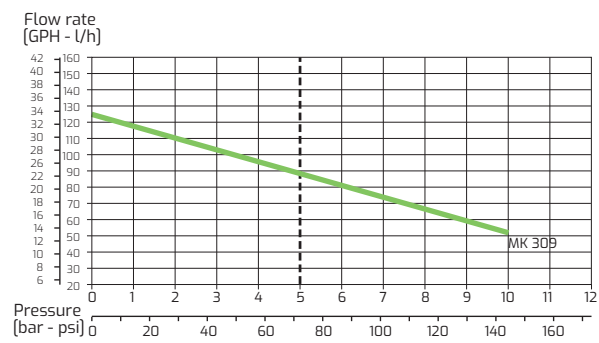

Note: For a continuous operation after the dotted line, a motor test is required. Characteristics with water at 20 °C (68 F) and without relief valve. Fluids different from water must be validated by the Customer. Temperature requirements different from ambient temperature must be mentioned on the order. Different materials are available upon request. Use a filter before the pump inlet no larger than 10 micron

